

# Whiting ColdSaver

## Insulated Roll-Up Door

World Class Quality  
Made in the USA.



### The Whiting Quality roll-up for temps below 20°F/-7°C

Designed especially for use on trucks and trailers carrying goods at extremely low temperatures. There are no fasteners or aluminum connectors through the door to conduct heat or cold therefore making it practically maintenance free and the toughest insulated roll-up you can buy.

The Whiting ColdSaver is a solid 37% more efficient in retaining cold than any other roll-up which results in both savings and peace of mind when it comes to shipping your freight.

Stainless Steel-Clad option includes all ColdSaver Door features plus Stainless Steel-faced panels along with optional stainless steel hardware inside and out.

### Product Features

- Durable panel system designed to withstand rugged use and operate at extremely low temperatures**
- Heavy duty .070" extruded aluminum panel faces**
- All panels designed with thermal breaks to eliminate heat transfer and adds structural strength**
- No thru-rivets allows for easy decaling and is not a source of heat transfer**
- Double sealed panel joints**
- Entire door perimeter is double sealed**
- Heavy duty 5600 bottom roller brackets**
- Two spring independent suspension balancer**
- 2" track and roller system**
- End hinges with easy roller change feature**
- Rigid bottom channel with replaceable seal**
- All door hardware E-Coated to prevent rust and corrosion**
- Self adjusting cam lock and other lock options available**

**Questions? Call Whiting for more information**

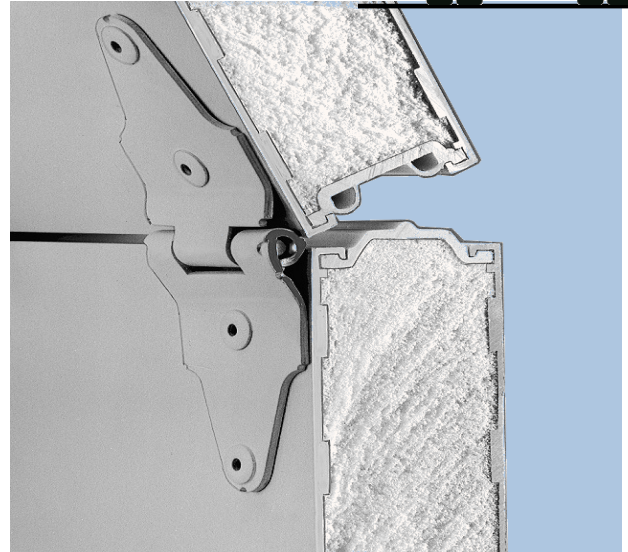

*Panels foamed-in-place with urethane insulation. Each joint is double sealed.*

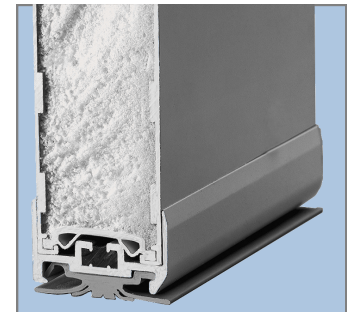

*Heavy duty aluminum channel and flexible seal features a rigid landing surface to protect seal.*

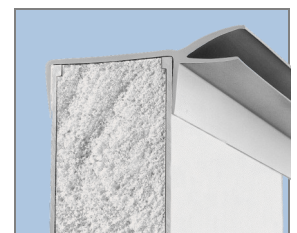

*Dual durometer PVC top seal forms double seal against the header.*



**Corporate Office:** 113  
Cedar Street Akron,  
New York 14001  
Phone: (716) 542-5427  
Fax: (716) 542-5947

**e-mail:** info@whitingdoor.com

**California Office:**  
301 S. Milliken Avenue  
Ontario, California 91761  
Phone: (909) 877-0120  
Fax: (909) 877-9180

**web:** whitingdoor.com

